

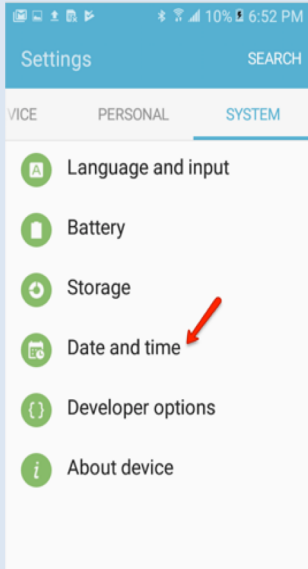

Contractor: Mobile Phone Set-Up

Every mobile phone needs to have the date/time set correctly.

1. Open Settings |
SYSTEM. Tap
[Date and time]



2. Tap [ON] to turn
the “Automatic date
and time” off

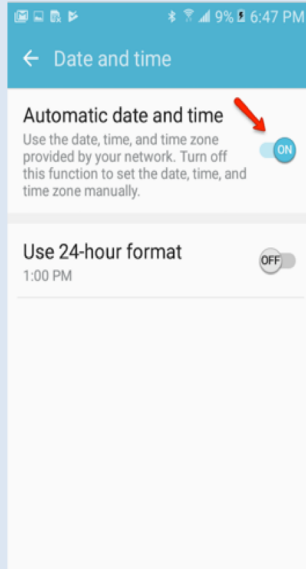

3. Tap [Select time
zone]. Tap the
correct location.

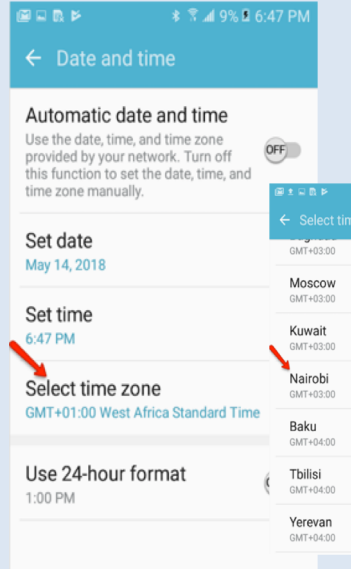

4. Tap [OFF] to turn
the “Automatic date
and time” ON again.

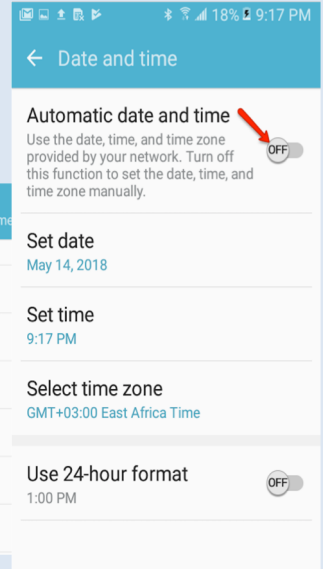

Every mobile phone needs to have the GPS activated.

1. Open Settings |
DEVICE. Tap
[Applications]

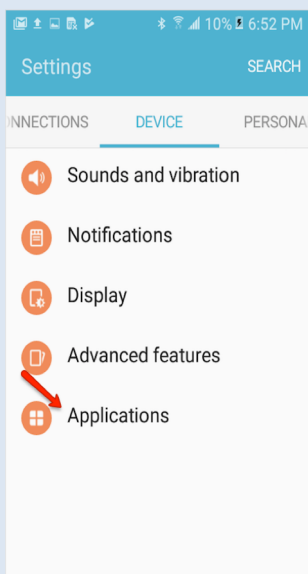

2. Tap [Camera]

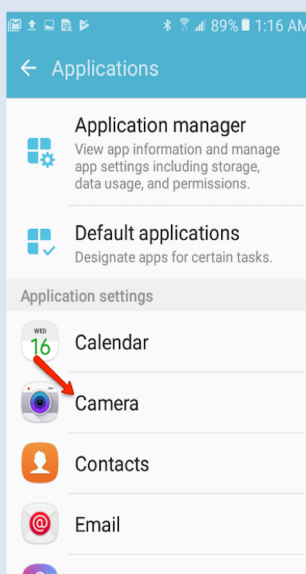

3. Check the
“Location tags”
button

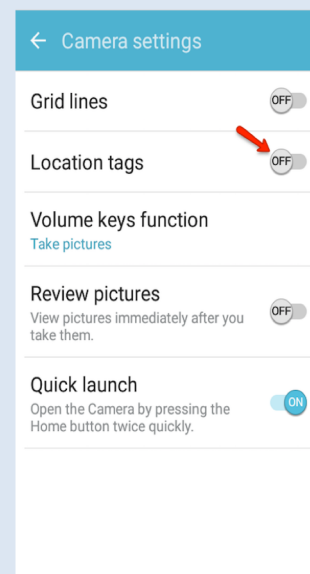

4. If it is [OFF], tap
the button to turn it
ON.

